



STATE OF DELAWARE
DEPARTMENT OF TRANSPORTATION
800 BAY ROAD
P.O. BOX 778
DOVER, DELAWARE 19903

JENNIFER COHAN
SECRETARY

VIA WEBSITE POSTING

November 16, 2018

Contract No. T201606114.01
Federal Aid Project No. NH-N018(20)
Main Street Newark Rehabilitation and Pedestrian Improvements
New Castle County

Ladies and Gentlemen:

Enclosed is Addendum No. 5 for the referenced contract consisting of the following:

1. The Bid Proposal Cover, revised, to be substituted for the same page in the Proposal.
2. The following Plan Sheets have been revised and replaced: 13, 15, 146, 147, 148, 149, 150, 154, and 156.

Please note the revisions listed above and submit your bid based upon this information.

Sincerely,

~signature on file~

Robert A. Kovacs
Competitively Bid Contracts Coordinator
Delaware Department of Transportation

STATE OF DELAWARE



DEPARTMENT OF TRANSPORTATION

BID PROPOSAL

for

CONTRACT T201606114.01

FEDERAL AID PROJECT NO. NH-N018(20)

CFDA NO. 20.205

Main Street Newark Rehabilitation and Pedestrian Improvements

New Castle County

ADVERTISEMENT DATE: October 15, 2018

COMPLETION TIME: 763564 - SPECIAL BIDDING PROCEDURES

PROSPECTIVE BIDDERS ARE ADVISED THAT THERE WILL BE A MANDATORY PRE-BID MEETING THURSDAY FRIDAY NOVEMBER 2, 2018 AT 2:00 P.M. IN THE DeIDOT ADMINISTRATION BUILDING, 800 BAY ROAD, DOVER, DELAWARE, 19903.

SPECIFICATIONS FOR ROAD AND BRIDGE CONSTRUCTION
DELAWARE DEPARTMENT OF TRANSPORTATION
AUGUST 2016

Bids will be received in the Bidder's Room at the Delaware Department of Transportation's Administration Building, 800 Bay Road, Dover, Delaware prior to 2:00 P.M. local time **November 20 27, 2018**

CURB SCHEDULE		
NO.	ITEM DESCRIPTION / TYPE	LENGTH
401	P. C. C CURB, TYPE 1-MODIFIED*	114.00
402	P. C. C CURB, TYPE 1-MODIFIED**	45.00
403	P. C. C CURB, TYPE 1-MODIFIED**	40.00
404	P. C. C CURB, TYPE 1-6	35.00
405	P. C. C CURB, TYPE 1-MODIFIED**	77.00
406	P. C. C CURB, TYPE 1-MODIFIED**	44.00
407	P. C. C CURB, TYPE 1-MODIFIED*	76.00
408	P. C. C CURB, TYPE 1-MODIFIED*	1.00
409	P. C. C CURB, TYPE 1-MODIFIED**	62.00
410	P. C. C CURB, TYPE 1-MODIFIED*	6.00
411	P. C. C CURB, TYPE 1-6	36.00
412	P. C. C CURB, TYPE 1-MODIFIED*	30.00

*SEE CONSTRUCTION DETAILS AND/OR GRADES AND GEOMETRIC SHEETS TO CALCULATE CURB REVEAL HEIGHT.
 ** 5" CURB REVEAL.

DRAINAGE INLET SCHEDULE						
NO.	STATION	OFFSET	BOX SIZE	GRATE	T. G. EL.	INV. EL.
401	1018+95.16	++	34" x 24"	4	+	+++
402	1019+51.67	++	34" x 24"	4	+	+++
403	1020+12.98	++	34" x 24"	4	+	+++
404	1020+65.43	++	34" x 24"	4	+	+++
405	1022+29.45	++	34" x 24"	4	+	116.57

+MATCH FLOWLINE OF PROPOSED CURB AND GUTTER.
 ++MATCH PROPOSED CURBLINE.
 +++MATCH EXISTING PIPE INVERT.

DRAINAGE PIPE SCHEDULE						
NO.	SIZE / TYPE	CLASS	LENGTH	SLOPE	INT. EL.	DIS. EL.
401	15" RCP	IV	127'	0.0099	116.57	115.32
402	15" RCP	IV	113'	0.0109	123.53	122.30

*MATCH EXISTING.
 ****SLOPE TO MATCH EXISTING INVERT.

CONVERT TO MANHOLE SCHEDULE						
NO.	STATION	OFFSET	TYPE/SIZE	T. G. EL.	INV. EL.	
401	1020+78.97	-19.08	***	**	*	

*MATCH EXISTING.
 **TO BE SET IN FIELD BY ENGINEER.
 ***SIZE OF MANHOLE TO MATCH EXISTING.

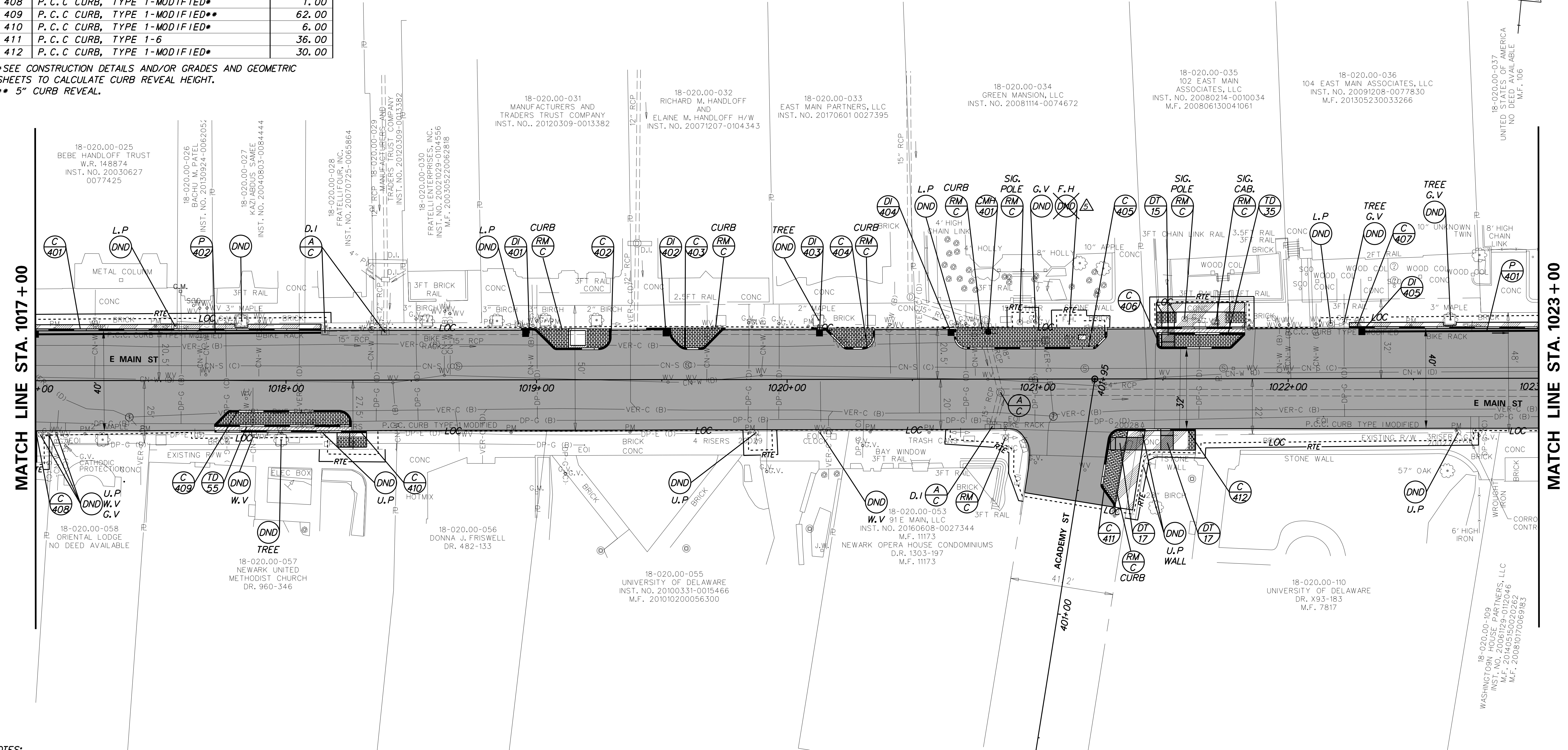

- NOTES:**
- 1- ANY EXISTING DEPRESSED CURB AT DRIVEWAY ENTRANCE THAT WILL EXCEED 1" LIP ABOVE FINISHED HOT-MIX TYPE C ELEVATION SHALL BE REPLACED AS DIRECTED BY THE ENGINEER.
 - 2- SEE CONSTRUCTION DETAIL PLANS FOR CURB RAMP DETAILS.
 - 3- OFFSETS SHOWN IN THE CONSTRUCTION TABLES WITH A MINUS SIGN ARE TO THE LEFT OF THE CONSTRUCTION BASELINE.
 - 4- EXISTING RIGHT-OF-WAY IS SHOWN FOR INFORMATIONAL PURPOSE ONLY. RIGHT-OF-WAY AS SHOWN IS BASED ON CONTRACT 98-007-03 FROM STA 1056+40 TO STA 1071+25.
 - 5- EXISTING RIGHT-OF-WAY IS SHOWN FOR INFORMATIONAL PURPOSE ONLY. RIGHT-OF-WAY AS SHOWN IS BASED ON CONTRACT 24-200-03 FROM STA 1034+70 TO STA 1056+40.

DELAWARE DEPARTMENT OF TRANSPORTATION

ADDENDUMS / REVISIONS	
1	REMOVED DND ON FIRE HYDRANT 11-13-18 GRP

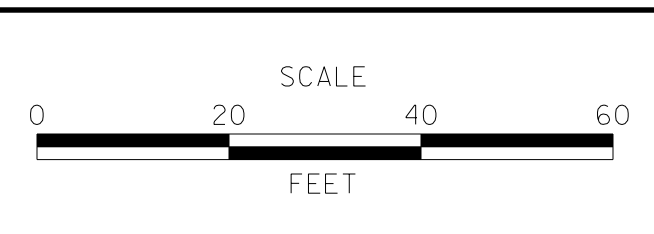

MAIN STREET NEWARK REHABILITATION AND PEDESTRIAN IMPROVEMENTS

CONTRACT	BRIDGE NO.	NA
T201606114	DESIGNED BY:	JAG
COUNTY	CHECKED BY:	GRP
NEW CASTLE		

CONSTRUCTION PLAN

CP-04
SHEET NO.
13
TOTAL SHTS.
190

CURB SCHEDULE		
NO.	ITEM DESCRIPTION / TYPE	LENGTH
601	P. C. C CURB, TYPE 1-6	34.00
602	P. C. C CURB, TYPE 1-MODIFIED*	23.00
603	P. C. C CURB, TYPE 1-MODIFIED**	76.00
605	P. C. C CURB, TYPE 1-MODIFIED*	36.00
606	P. C. C CURB, TYPE 1-MODIFIED*	10.00
607	P. C. C CURB, TYPE 1-6	17.00
608	P. C. C CURB, TYPE 1-MODIFIED**	32.00
609	P. C. C CURB, TYPE 1-MODIFIED*	64.00
610	P. C. C CURB, TYPE 1-MODIFIED*	44.00
611	P. C. C CURB, TYPE 1-MODIFIED*	26.00

DRAINAGE INLET SCHEDULE						
NO.	STATION	OFFSET	BOX SIZE	GRATE	T.G. EL.	INV. EL.
601	1029+01.42	++	34" x 24"	4	+	+++
602	1031+42.37	++	34" x 24"	4	+	112.64
603	1031+76.56	++	34" x 24"	4	+	+++
604	1031+90.43	++	34" x 24"	4	+	+++
605	1034+68.09	++	34" x 24"	4	+	112.08

DRAINAGE PIPE SCHEDULE						
NO.	SIZE / TYPE	CLASS	LENGTH	SLOPE	INT. EL.	DIS. EL.
601	15" RCP	IV	7'	*	112.64	****
602	15" RCP	IV	8'	*	112.08	****

MANHOLE SCHEDULE					
NO.	STATION	OFFSET	TYPE/SIZE	T.G. EL.	INV. EL.
601	1031+42.93	-10.58	***	**	*
602	1034+68.08	-10.50	***	**	*

*MATCH FLOWLINE OF PROPOSED CURB AND GUTTER.
 **MATCH PROPOSED CURBLINE.
 ***MATCH EXISTING PIPE INVERT.

*MATCH EXISTING.
 ****SLOPE TO MATCH EXISTING INVERT.

*MATCH EXISTING.
 **TO BE SET IN FIELD BY ENGINEER.
 ***SIZE OF MANHOLE TO MATCH EXISTING.

CONVERT TO MANHOLE SCHEDULE					
NO.	STATION	OFFSET	TYPE/SIZE	T.G. EL.	INV. EL.
601	1031+72.23	-21.82	***	**	*

*MATCH EXISTING.
 **TO BE SET IN FIELD BY ENGINEER.
 ***SIZE OF MANHOLE TO MATCH EXISTING.

*SEE CONSTRUCTION DETAILS AND/OR GRADES AND GEOMETRIC SHEETS TO CALCULATE CURB REVEAL HEIGHT.
 ** 5" CURB REVEAL.

MATCH LINE STA. 1029+00

MATCH LINE STA. 1035+00

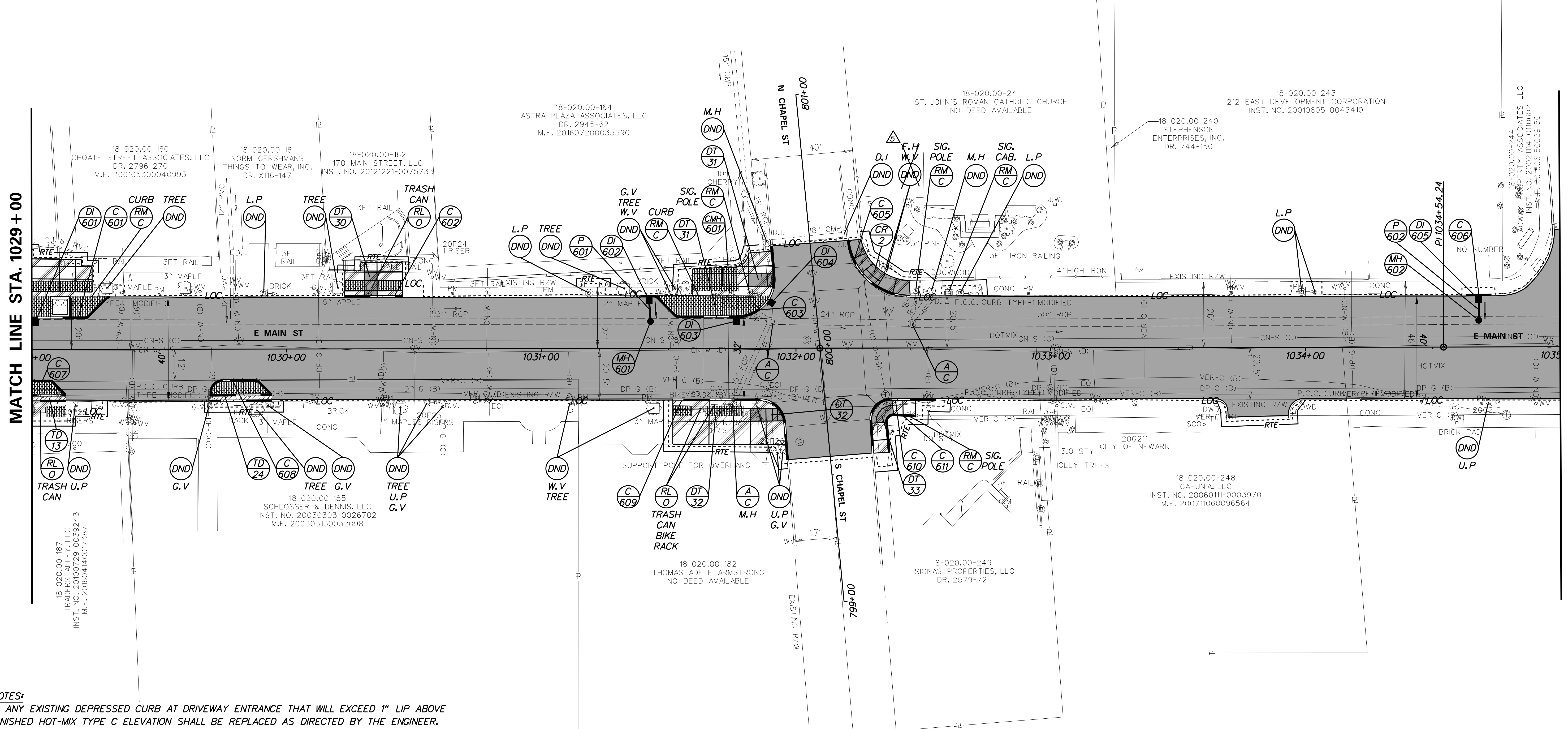

- NOTES:**
- 1- ANY EXISTING DEPRESSED CURB AT DRIVEWAY ENTRANCE THAT WILL EXCEED 1" LIP ABOVE FINISHED HOT-MIX TYPE C ELEVATION SHALL BE REPLACED AS DIRECTED BY THE ENGINEER.
 - 2- SEE CONSTRUCTION DETAIL PLANS FOR CURB RAMP DETAILS.
 - 3- OFFSETS SHOWN IN THE CONSTRUCTION TABLES WITH A MINUS SIGN ARE TO THE LEFT OF THE CONSTRUCTION BASELINE.
 - 4- EXISTING RIGHT-OF-WAY IS SHOWN FOR INFORMATIONAL PURPOSE ONLY. RIGHT-OF-WAY AS SHOWN IS BASED ON CONTRACT 98-007-03 FROM STA 1056+40 TO STA 1071+25.
 - 5- EXISTING RIGHT-OF-WAY IS SHOWN FOR INFORMATIONAL PURPOSE ONLY. RIGHT-OF-WAY AS SHOWN IS BASED ON CONTRACT 24-200-03 FROM STA 1034+70 TO STA 1056+40.

ADDENDUMS / REVISIONS

5	REMOVED DND ON FIRE HYDRANT & WATER VALVE 11-13-18 GRP
---	--

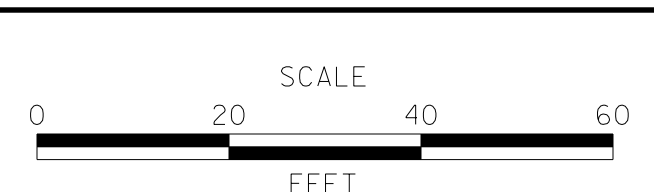

**MAIN STREET NEWARK
 REHABILITATION AND
 PEDESTRIAN IMPROVEMENTS**

CONTRACT	BRIDGE NO.	N/A
T201606114	DESIGNED BY:	JAG
COUNTY	CHECKED BY:	GRP
NEW CASTLE		

CONSTRUCTION PLAN

CP-06
SHEET NO.
15
TOTAL SHTS.
190

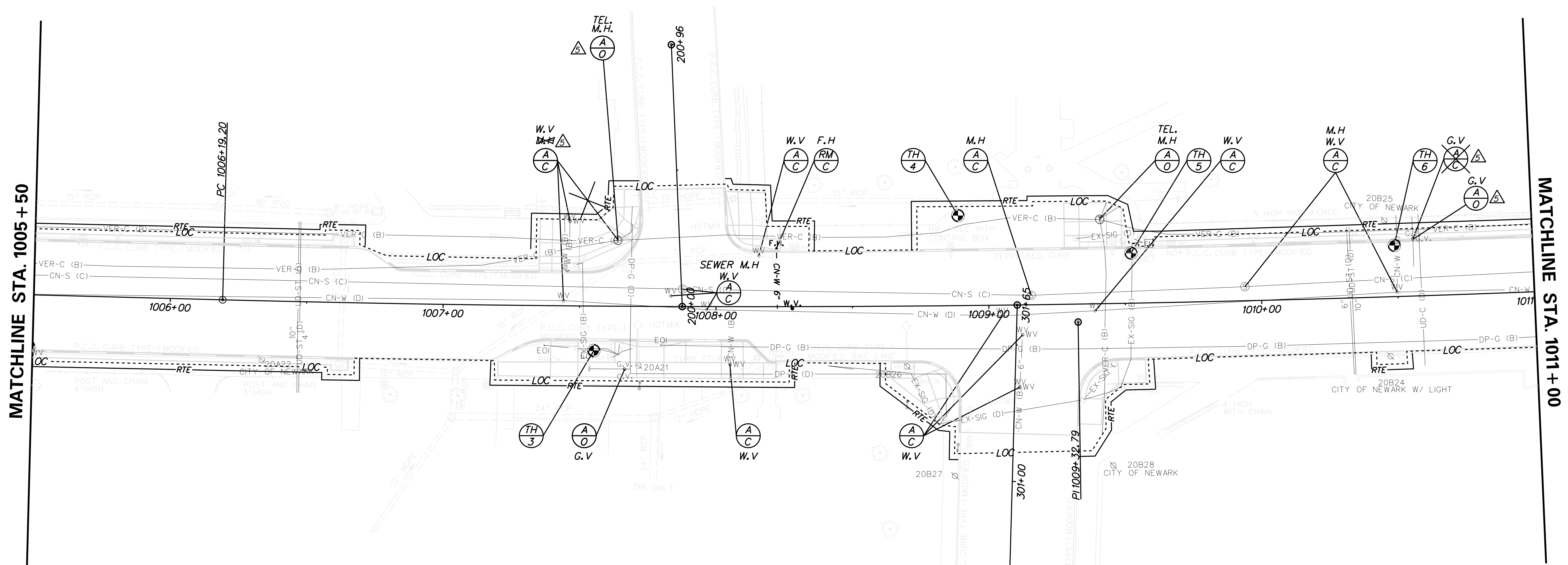
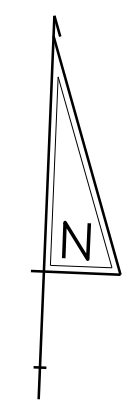

UTILITY TEST HOLE SCHEDULE						
NO.	UTILITY	STATION	OFFSET	GRND EL.	COVER	O. D. & MATERIAL
TH-3	MAST ARM	1007+55.35	16.32'	134.38	1.72	3" STEEL COND.
TH-4	MAST ARM	1008+89.00	-33.01'	135.05	0.00	NO UTILITY
TH-5	DP-E	1009+52.44	18.34'	134.43	1.58	2.5" STEEL COND
TH-6	CN-W	1010+49.18	18.76'	134.87	3.89	8" CAST IRON
TH-6A	UD-S	1010+32.33	-17.67'	134.71	10.52	UNKNOWN
TH-6B	UD-C	1010+58.43	-17.39'	134.86	5.16	12" CAST IRON

\\USPHL\FP002\DATA\PROJECTS\60318855\TASK 6 - P&R NORTH XIV\900 - WORK\910 - CAD\05 - REFERENCES\UT-00.DGN (UT-02)

DELAWARE DEPARTMENT OF TRANSPORTATION

ADDENDUMS / REVISIONS	
1	CHANGED A/C TO A/O FOR GAS AND TELEPHONE 11/13/18 GRP

**MAIN STREET NEWARK
REHABILITATION AND
PEDESTRIAN IMPROVEMENTS**

CONTRACT	BRIDGE NO.	N/A
T201606114	DESIGNED BY:	JAG
COUNTY	CHECKED BY:	GRP
NEW CASTLE		

UTILITY RELOCATION PLAN

UT-02
SHEET NO.
146
TOTAL SHTS.
190

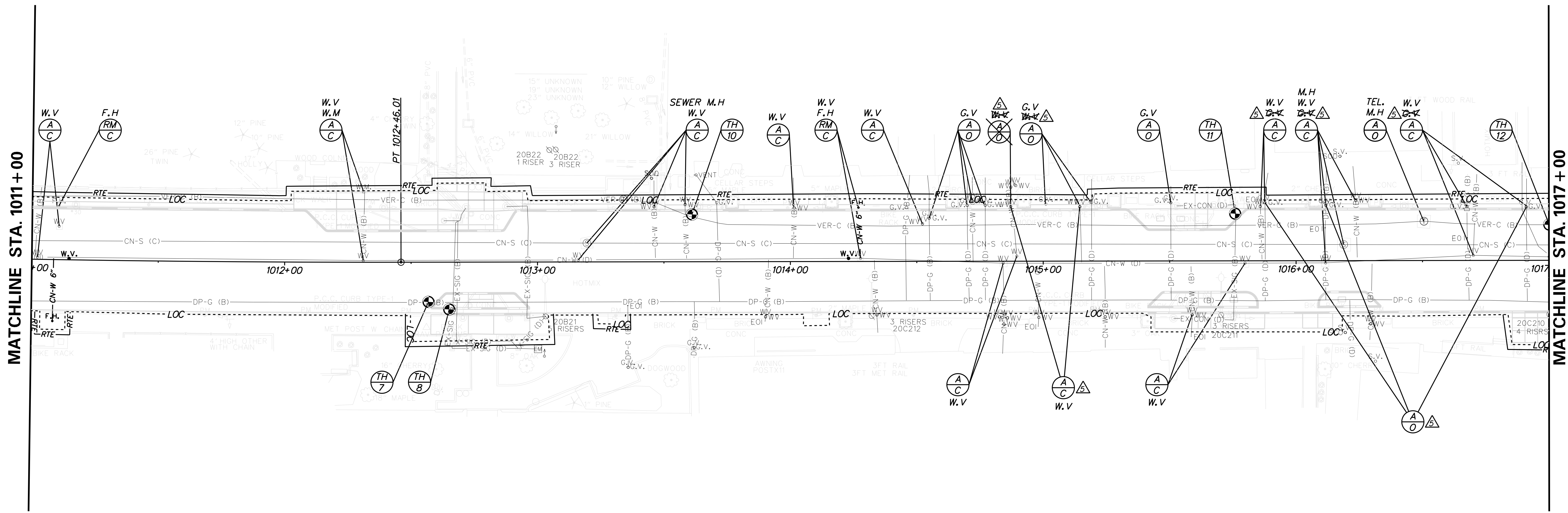
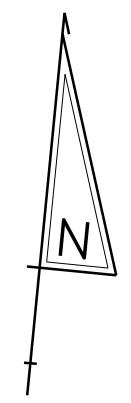

UTILITY TEST HOLE SCHEDULE						
NO.	UTILITY	STATION	OFFSET	GRND EL.	COVER	O. D. & MATERIAL
TH-7	DP-G	1012+56.87	15.71'	132.13	2.32	6" STEEL
TH-8	DELDOT	1012+66.47	18.29'	131.89	2.06	4" PVC
TH-8A	DELDOT	1012+68.16	18.21'	131.85	2.03	4" PVC
TH-10	VER	1013+61.09	-18.69'	129.97	4.78	15"X15" CONC.
TH-11	DELDOT	1015+75.93	-18.65'	127.68	1.49	2" STEEL COND.
TH-12	VER	1017+00.01	-14.39'	126.40	5.69	15"X15" CONC.

\\USPHL\FP002\DATA\PROJECTS\60318855\TASK_6 - P&R NORTH XIV\900 - WORK\910 - CAD\05 - REFERENCES\UT_00.DGN (UT-03)

	ADDENDUMS / REVISIONS	MAIN STREET NEWARK REHABILITATION AND PEDESTRIAN IMPROVEMENTS	CONTRACT	BRIDGE NO.	N/A	UTILITY RELOCATION PLAN	SHEET NO.
	CHANGED A/C TO A/O FOR GAS AND TELEPHONE 11/13/18 GRP		T201606114	DESIGNED BY: JAG	TOTAL SHTS.		
			COUNTY	CHECKED BY: GRP			190
			NEW CASTLE				

\\USPH\IP002\DATA\PROJECTS\60318855\TASK_6 - P&R NORTH XIV\900 - WORK\910 - CAD\05 - REFERENCES\UT_00.DGN (UT-04)



MATCHLINE STA. 1017 + 00

MATCHLINE STA. 1023 + 00

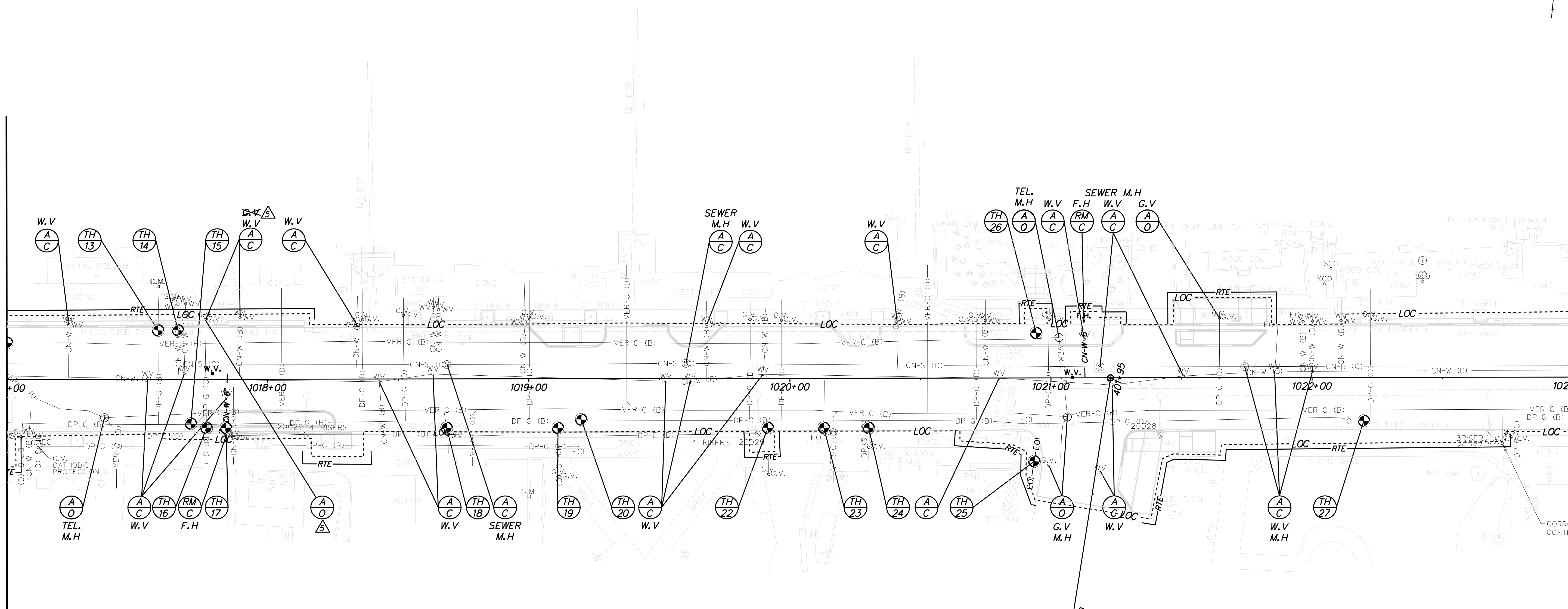

UTILITY TEST HOLE SCHEDULE						
NO.	UTILITY	STATION	OFFSET	GRND EL.	COVER	O. D. & MATERIAL
TH-13	DP-G	1017+58.00	-18.78'	125.77	2.22	0.75" POLYETH.
TH-14	CN-2W	1017+65.67	-18.88	125.66	0.00	NO UTILITY
TH-14A	DP-G	1017+05.96	17.74'	126.26	2.84	2" POLYETHYLENE
TH-15	DP-G	1017+70.49	16.96'	125.63	2.40	6" STEEL
TH-16	DP-G	1017+76.49	18.63'	125.56	2.05	1/2" POLYETHYL.
TH-17	CN-W	1017+83.94	18.64'	125.48	2.87	1" COPPER
TH-17A	CN-W	1017+83.89	17.93'	125.57	3.27	8" CAST IRON
TH-18	CN-W	1018+68.49	18.76'	124.66	3.18	3/4" COPPER
TH-18A	CN-W	1018+44.05	17.83'	124.93	4.39	8" DUCT. IRON
TH-19	DP-G	1019+11.12	18.81'	124.00	0.00	NO UTILITY
TH-20	DP-G	1019+20.04	15.65'	123.86	2.74	6" STEEL
TH-22	DP-G	1019+91.51	18.92'	122.43	2.21	1.25" STEEL
TH-22A	DP-G	1019+97.98	19.47'	122.45	1.85	4.5" X4" WOOD
TH-23	CN-W	1020+12.98	18.95'	122.15	2.51	1" COPPER
TH-24	DP-G	1020+30.12	18.97'	121.85	2.28	1.25" STEEL
TH-25	MAST ARM	1020+93.57	31.92'	120.94	1.81	4" X7" CONCRETE
TH-26	MAST ARM	1020+94.33	-17.25'	120.95	3.47	UNK. CONCRETE
TH-27	DP-G	1022+19.84	16.60'	119.49	2.48	6" STEEL

DELAWARE DEPARTMENT OF TRANSPORTATION

ADDENDUMS / REVISIONS
 CHANGED A/C TO A/O FOR GAS AND TELEPHONE 11/13/18 GRP

MAIN STREET NEWARK
 REHABILITATION AND
 PEDESTRIAN IMPROVEMENTS

CONTRACT
 T201606114
 COUNTY
 NEW CASTLE
 BRIDGE NO.
 N/A
 DESIGNED BY: JAG
 CHECKED BY: GRP

UTILITY RELOCATION PLAN

UT-04
 SHEET NO.
 148
 TOTAL SHTS.
 190

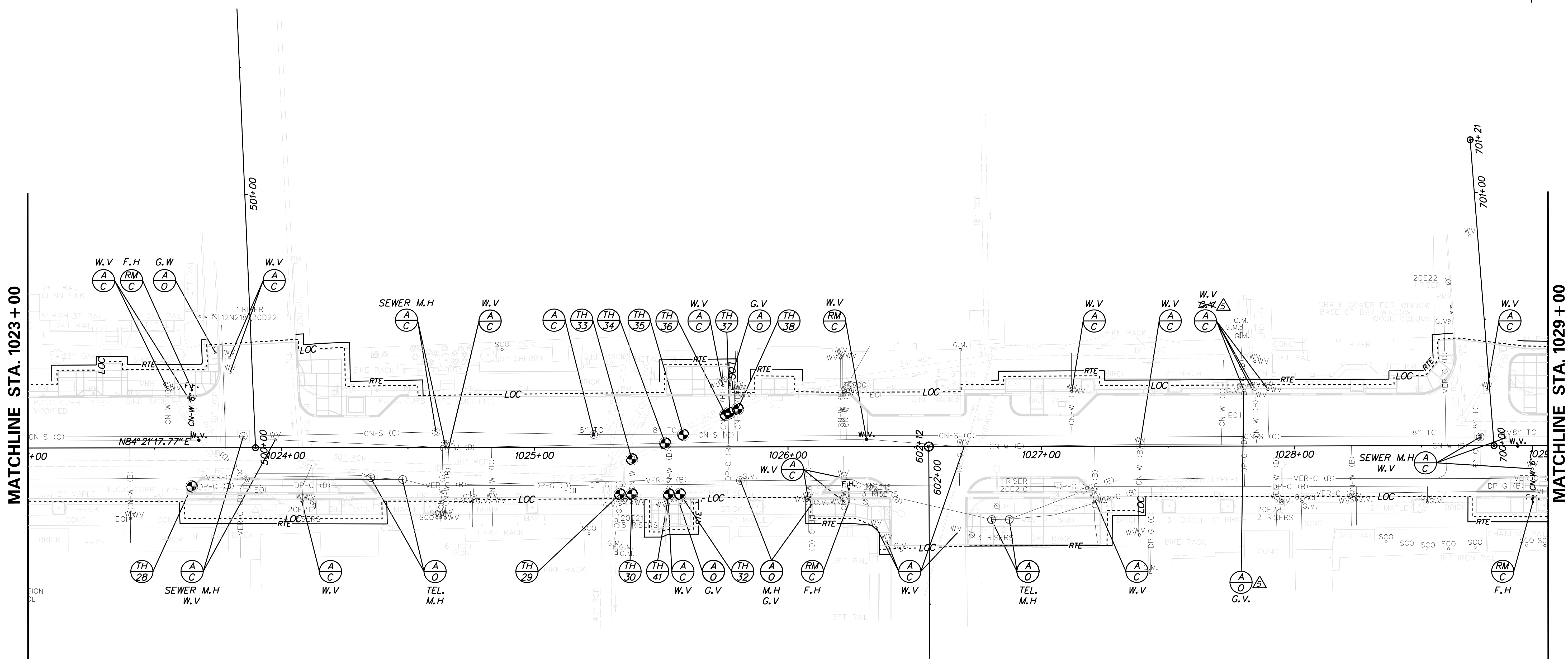
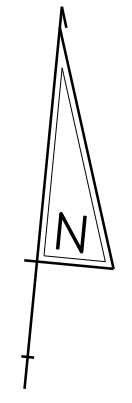

UTILITY TEST HOLE SCHEDULE						
NO.	UTILITY	STATION	OFFSET	GRND EL.	COVER	O. D. & MATERIAL
TH-28	DP-G	1023+64.66	15.23'	118.14	2.66	6" STEEL
TH-29	DP-G	1025+33.64	18.61'	116.76	2.57	1" STEEL
TH-30	CN-W	1025+38.36	18.61'	116.74	2.28	1" COPPER
TH-31	CN-W	1025+52.92	18.61'	116.81	3.21	3/4" COPPER
TH-32	DP-G	1025+57.41	18.61'	116.82	2.36	1.25" STEEL
TH-33	CN-W	1025+38.37	4.79'	116.99	3.42	3/4" COPPER
TH-34	CN-W	1025+51.56	-1.45'	117.09	3.11	UNKNOWN
TH-35A	CN-S	1025+23.29	-4.97'	117.10	8.05	8" TERRA COTTA
TH-35B	CN-S	1028+73.25	-3.46'	117.36	8.86	8" TERRA COTTA
TH-36	CN-W	1025+75.39	-12.71'	116.97	3.46	1.25" COPPER
TH-37	DP-G	1025+76.94	-13.44'	116.92	2.68	1.75" STEEL
TH-38	CN-W	1025+80.20	-14.98'	116.68	3.18	(2) 2" COPPER

\\USPHL\FP002\DATA\PROJECTS\60318855\TASK 6 - P&R NORTH XIV\900 - WORK\910 - CAD\05 - REFERENCES\UT_00.DGN (UT-05)

\\USPHL\FP002\DATA\PROJECTS\60318855\TASK 6 - P&R NORTH XIV\900 - WORK\910 - CAD\05 - REFERENCES\UT_00.DGN (UT-06)

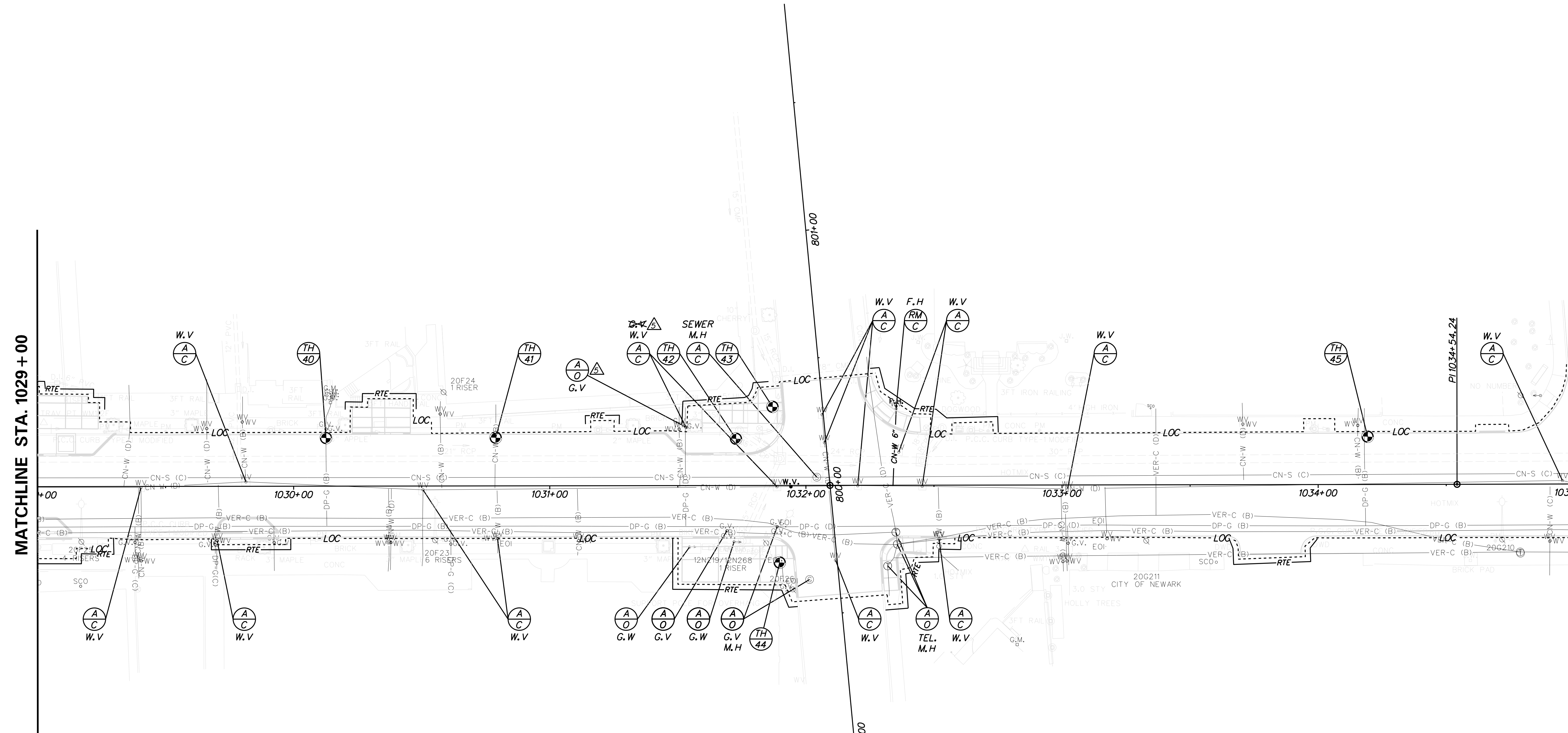
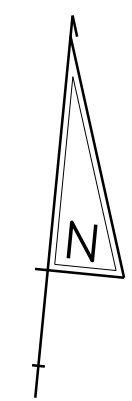

UTILITY TEST HOLE SCHEDULE						
NO.	UTILITY	STATION	OFFSET	GRND EL.	COVER	O. D. & MATERIAL
TH-40	DP-G	1030+12.65	-18.80'	116.28	2.71	1" STEEL
TH-41	CN-W	1030+78.93	-18.80'	115.83	2.23	1" COPPER
TH-42	MAST ARM	1031+72.72	-18.24'	115.55	0.00	NO UTILITIES
TH-43	MAST ARM	1031+88.55	-31.59'	116.01	0.00	NO UTILITIES
TH-43A	MAST ARM	1031+90.11	-33.08'	116.03	3.28	18" RCP
TH-44	MAST ARM	1031+90.80	31.55'	115.68	0.00	NO UTILITIES
TH-44A	MAST ARM	1031+89.72	30.08'	115.65	2.15	6" POLYETHYL.
TH-45	DP-G	1034+21.47	-18.42'	116.13	0.00	NO UTILITIES
TH-45A	DP-G	1034+19.34	-18.68'	116.10	2.80	1" STEEL

DELAWARE DEPARTMENT OF TRANSPORTATION

ADDENDUMS / REVISIONS	
	CHANGED A/C TO A/O FOR GAS AND TELEPHONE 11/13/18 GRP

**MAIN STREET NEWARK
REHABILITATION AND
PEDESTRIAN IMPROVEMENTS**

CONTRACT	BRIDGE NO.	NA
T201606114	DESIGNED BY:	JAG
COUNTY	CHECKED BY:	GRP
NEW CASTLE		

UTILITY RELOCATION PLAN

UT-06
SHEET NO.
150
TOTAL SHTS.
190

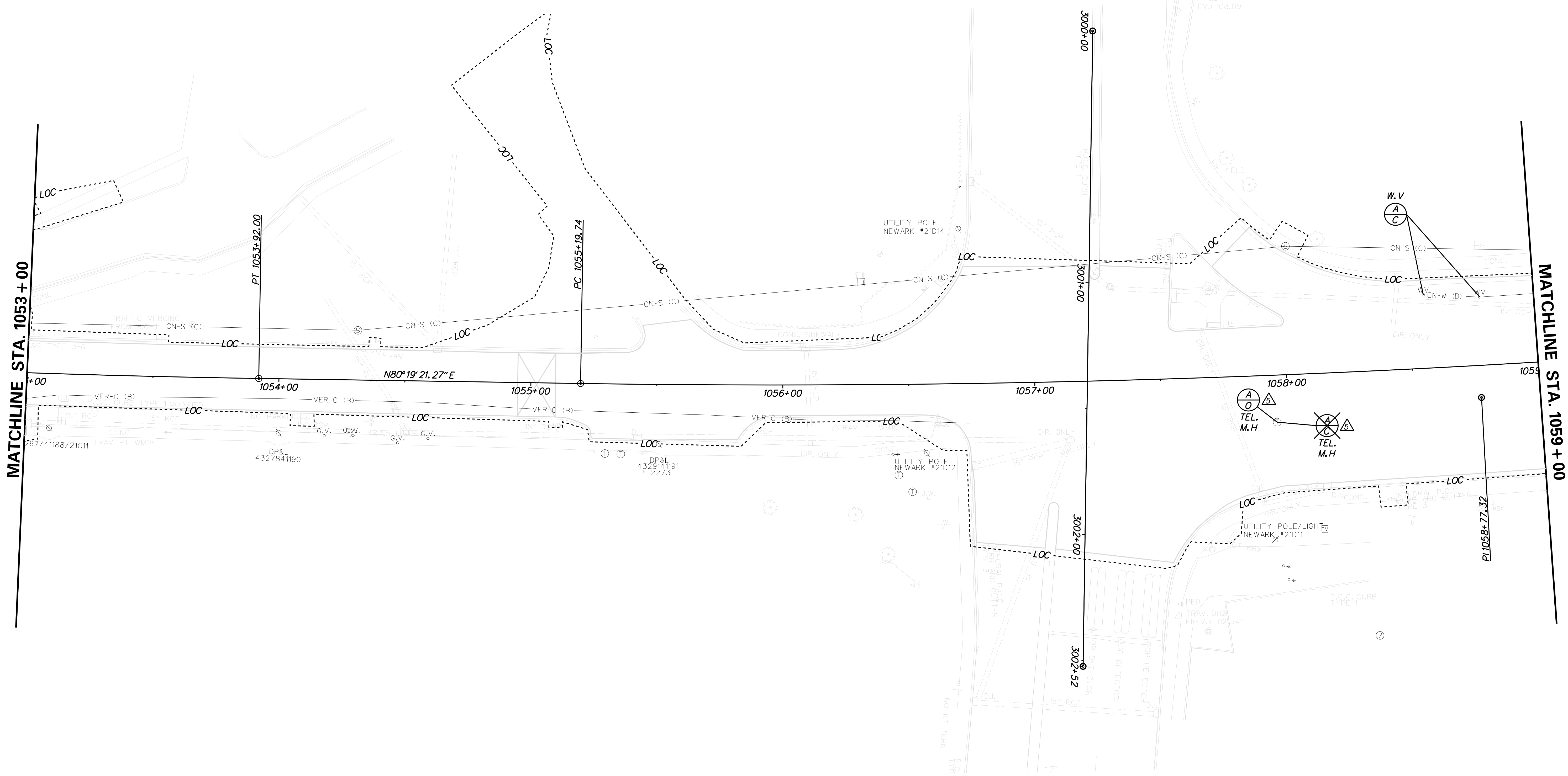
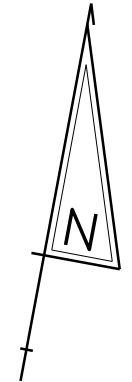

\\USPHL\FP002\DATA\PROJECTS\60318855\TASK_6 - P&R NORTH XIV\900 - WORK\910 - CAD\05 - REFERENCES\UT-10

DELAWARE DEPARTMENT OF TRANSPORTATION	ADDENDUMS / REVISIONS CHANGED A/C TO A/O FOR GAS AND TELEPHONE 11/13/18 GRP		MAIN STREET NEWARK REHABILITATION AND PEDESTRIAN IMPROVEMENTS	CONTRACT T201606114 COUNTY NEW CASTLE	BRIDGE NO. N/A DESIGNED BY: JAG CHECKED BY: GRP	UTILITY RELOCATION PLAN	SHEET NO. 154 TOTAL SHTS. 190

UT-10

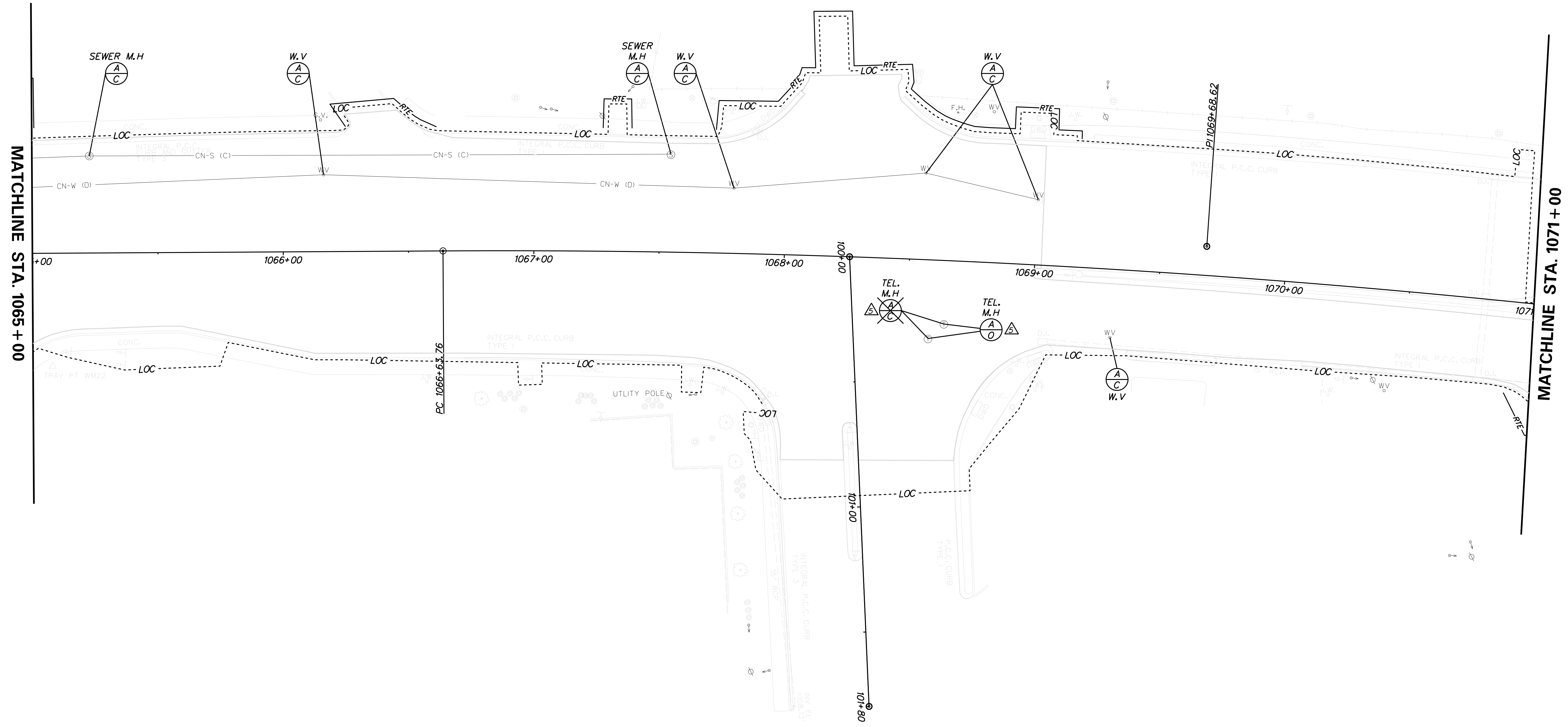
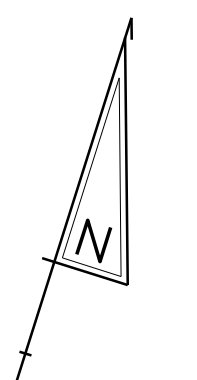

\\USPHL\FP002\DATA\PROJECTS\60318855\TASK_6 - P&R NORTH XIV\900 - WORK\910 - CAD\05 - REFERENCES\UT-12

	DELWARE DEPARTMENT OF TRANSPORTATION	ADDENDUMS / REVISIONS 1 CHANGED A/C TO A/O FOR GAS AND TELEPHONE 11/13/18 GRP		MAIN STREET NEWARK REHABILITATION AND PEDESTRIAN IMPROVEMENTS	CONTRACT T201606114 COUNTY NEW CASTLE	BRIDGE NO. N/A DESIGNED BY: JAG CHECKED BY: GRP	UTILITY RELOCATION PLAN	SHEET NO. 156 TOTAL SHTS. 190

UT-12